



EIGHT DIFFERENT FITPOWER STUDIO FLOOR PLANS

(from 49 to 450 sq. ft.)

- | | |
|--|-------------|
| 1. Single WBV Workout Station (for existing businesses)..... | 49 sq. ft. |
| 2. Two WBV Workout Stations (for existing businesses)..... | 84 sq. ft. |
| 3. Four WBV Workout Stations (for existing businesses)..... | 310 sq. ft. |
| 4. Six WBV Workout Stations (for existing businesses)..... | 324 sq. ft. |
| 5. Five WBV Workout Stations
(stand alone business) | 324 sq. ft. |
| 6. Five WBV Workout Stations + Two POD Cabins
(stand alone business)..... | 450 sq. ft. |
| 7. Three WBV Workout Stations (for existing businesses)..... | 216 sq. ft. |
| 8. Four WBV Workout Stations + Two POD Cabins (for existing
businesses)..... | 342 sq. ft. |

7'

7'

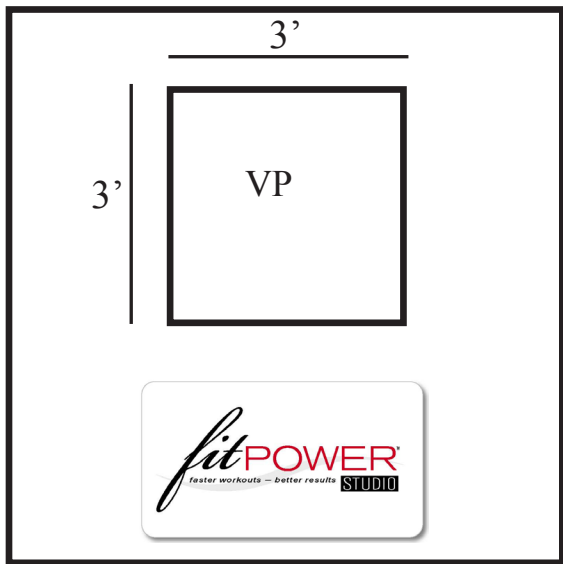

Floor Plan No.1'

*1 WBV Station

Single Workout Station Plan

“Perfectly Fits Your Existing Business”

SQFT = 49

12'

7'



3'

3'

Floor Plan No.2

*2 WBV Stations

“Perfectly Fits Your Existing
Business”

SQFT = 84



6'

31'

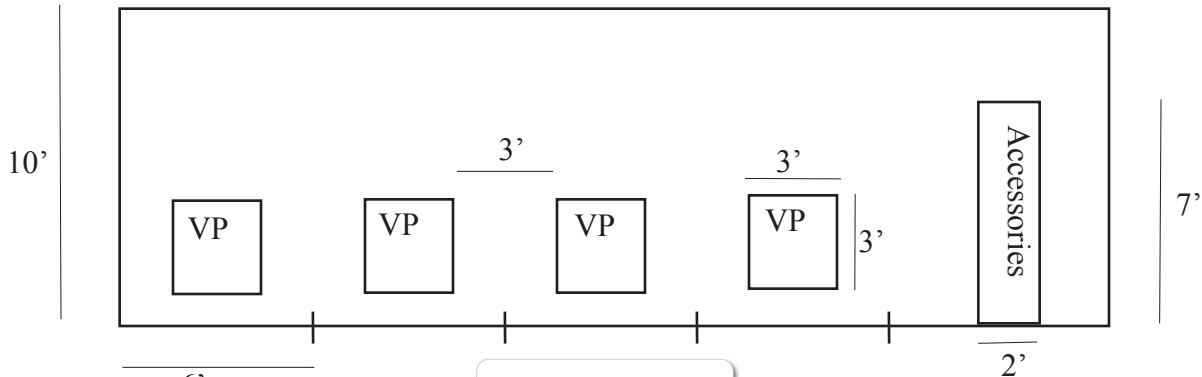

Floor Plan No.3
*Four WBV Stations
“Perfectly Fits Your Existing Business”
SQFT = 310

Floor Plan No.4

*Six WBV Stations

Perfectly fits your existing business

SQFT = 324'

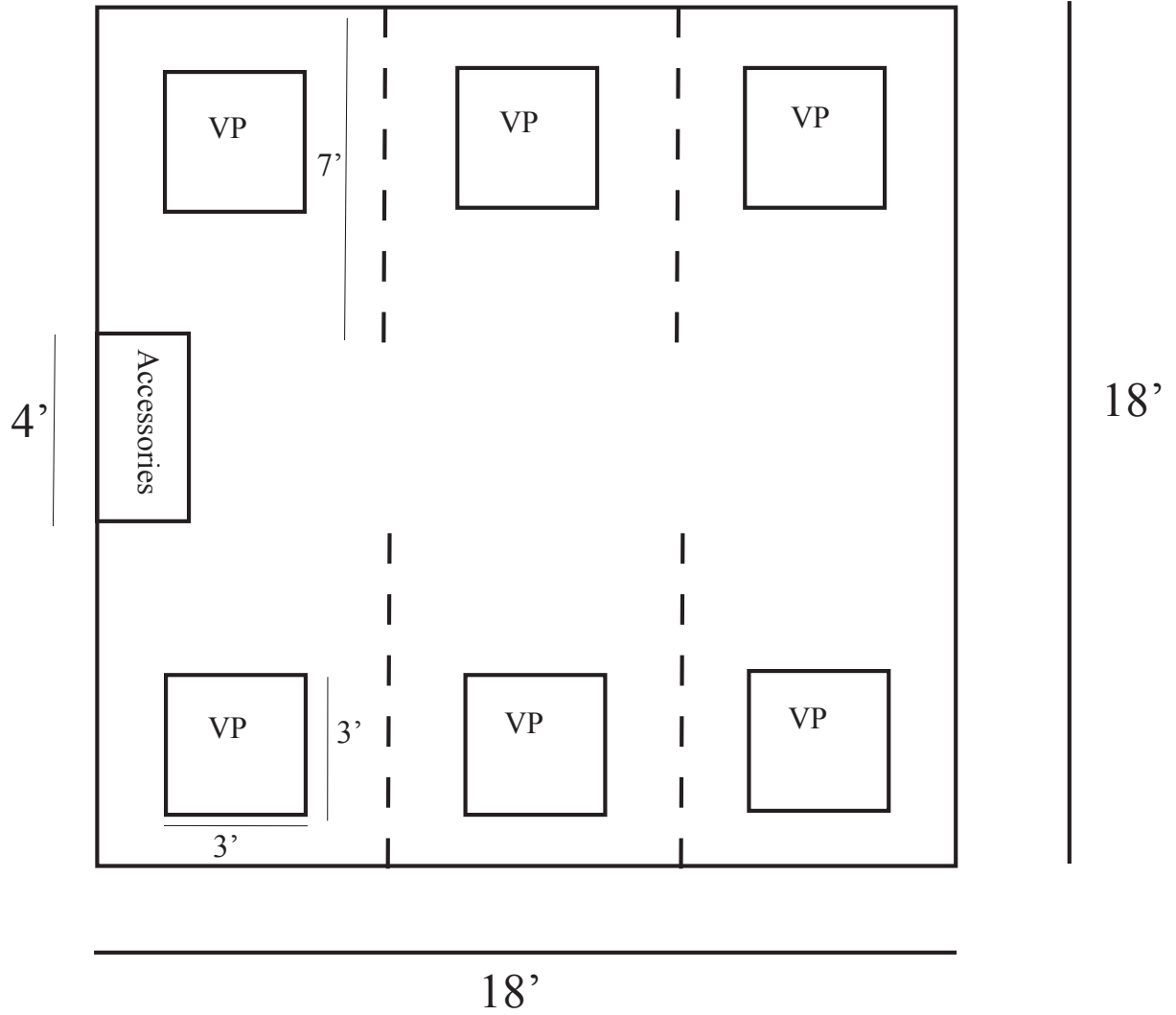

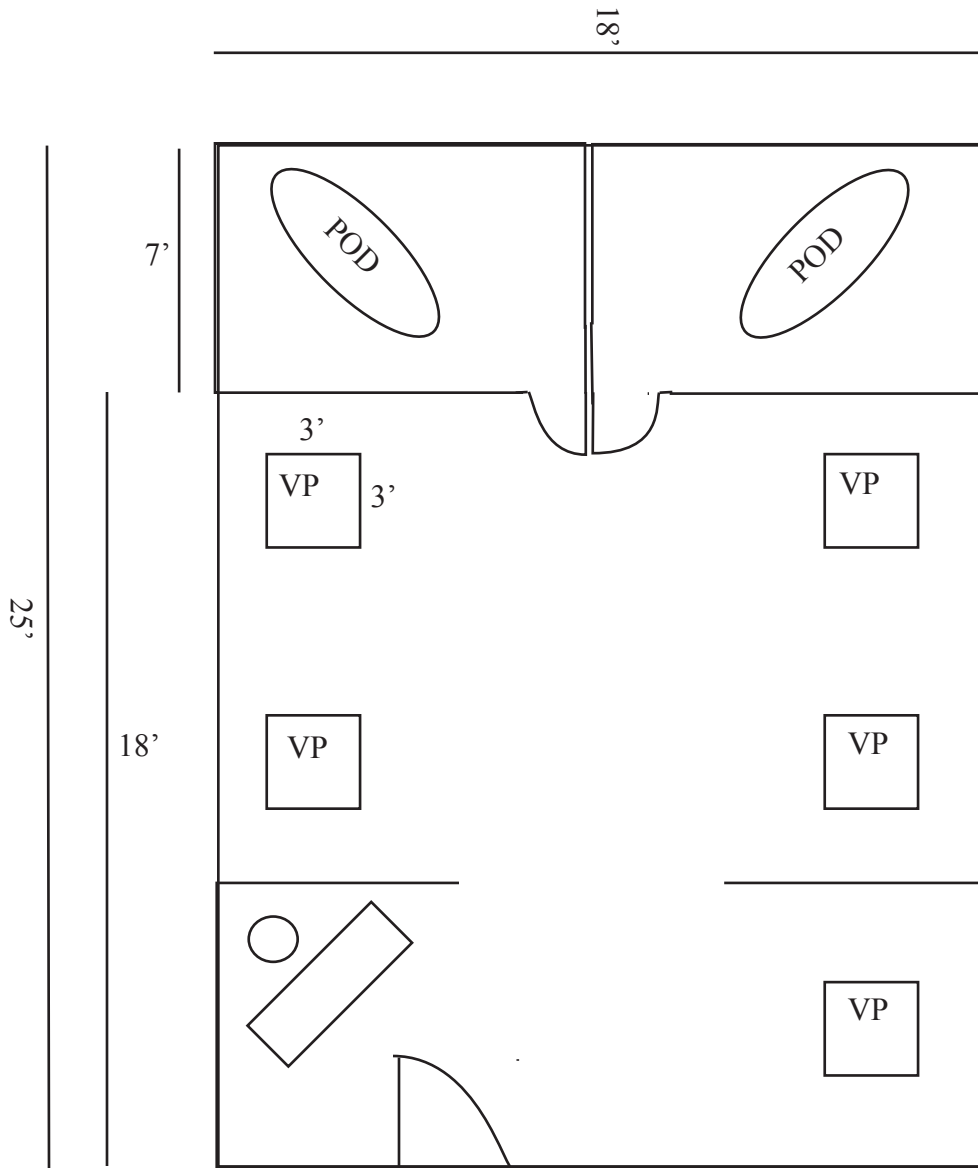

Floor Plan No. 6
 *Five WBV Stations
 *Two POD private-cabins
 Standalone Business Model
 Standalone - "The most compact fitness studio in the world"
 SQFT = 450

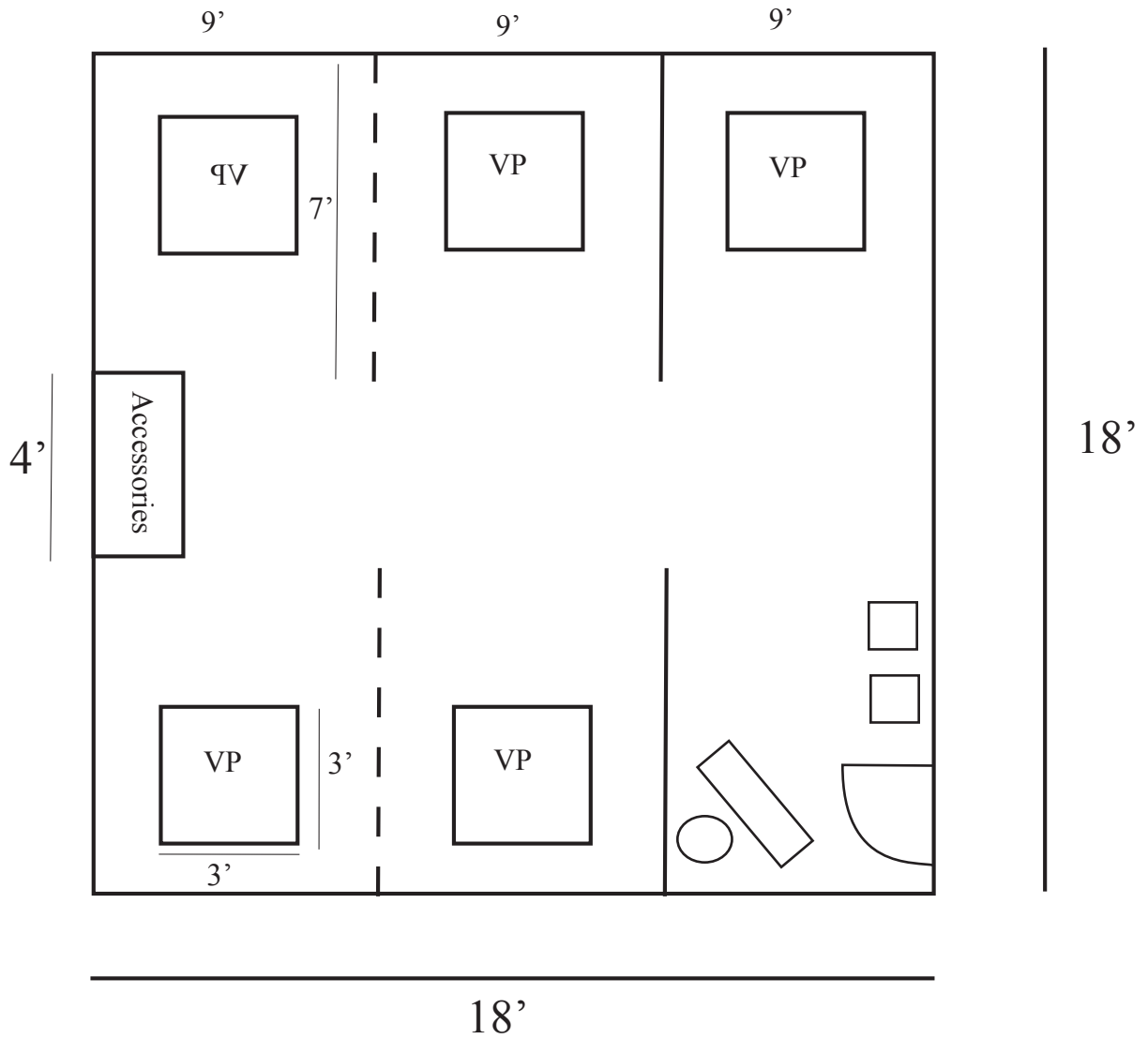

Floor Plan No. 5
 *Five WBV Stations
 Standalone Business Model
 Standalone - "The most compact fitness studio in the world"
 SQFT = 324

Floor Plan No.7
*3 WBV Stations
Perfectly fits your existing business

SQFT = 216'

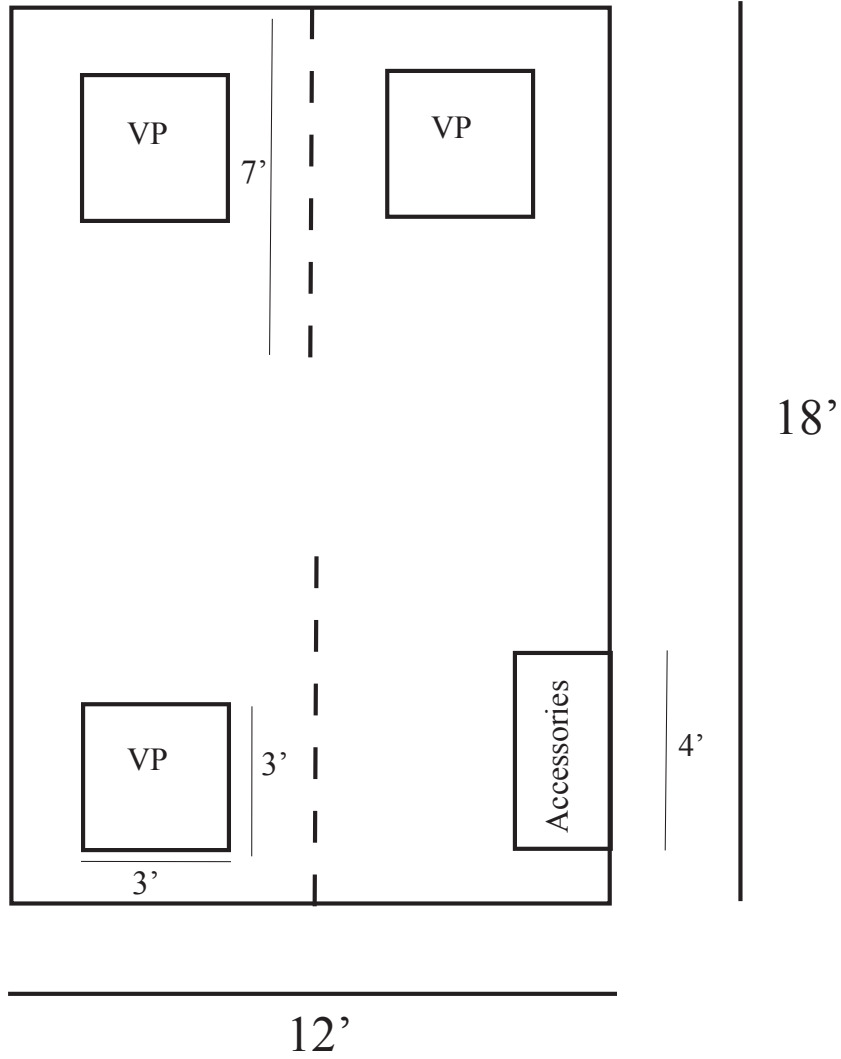

Floor Plan No.8

*4 WBV Stations

* 2 PODS

Perfectly fits your existing business

SQFT = 342'

